

MIG/MAG TORCH AIR COOLED - MODEL MA25

60% DUTY CYCLE
CO₂ GAS - 250A
MIX GAS - 220A
WIRE SIZE - 0.8 - 1.2

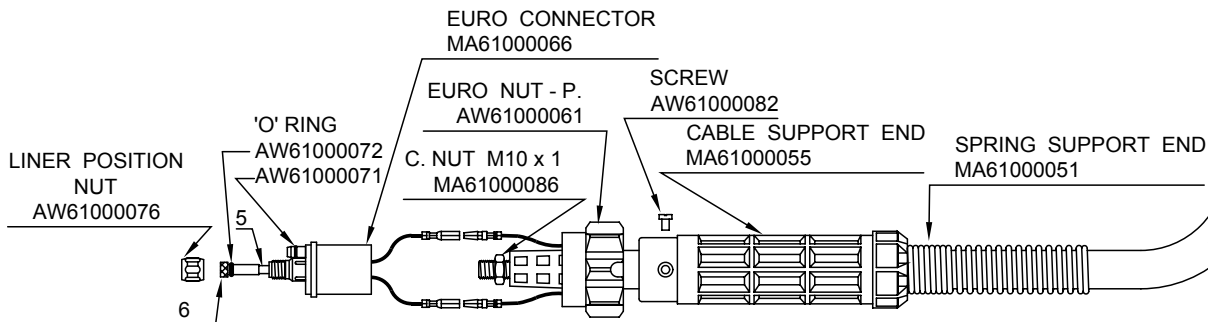
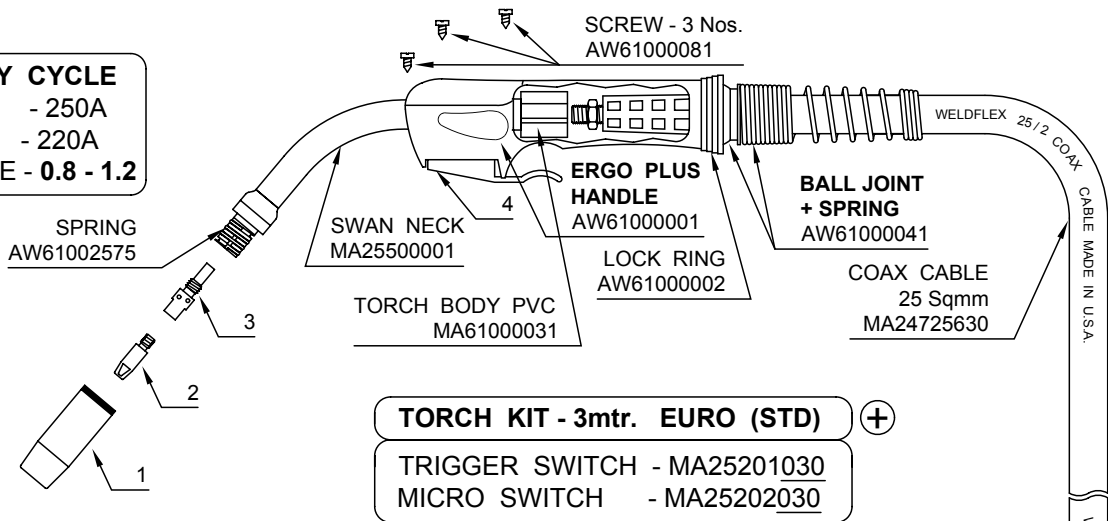

PART NUMBERS ARE FOR 3 METRE LENGTH TORCH
 FOR ANY OTHER LENGTH CORRECT LAST THREE DIGITS.
 LAST DIGIT FOR FRACTION OF METRE
 FOR EXAMPLE : 4.5 METRE WITH TRIGGER SWITCH - MA25201045
 5.0 METRE WITH MICRO SWITCH - MA25202050

<p>① GAS NOZZLE</p> <p>TAPER AW11255711 CONICAL AW12255715 CYLINDRICAL AW13255718 SPOT WELDING AW14255718</p>	<p>② CONTACT TIP (X)</p> <p>ECU - STEEL WIRE</p> <p>DIA 8 x M6 x L28 AW210828XX DIA 10 x M8 x L30 AW211030XX</p> <p>CUCRZR - STEEL WIRE</p> <p>DIA 8 x M6 x L28 AW220828XX DIA 10 x M8 x L30 AW221030XX</p> <p>ECU - NON FERROUS WIRE</p> <p>DIA 8 x M6 x L28 AW230828XX DIA 10 x M8 x L30 AW231030XX</p>	<p>⑤ LINER</p> <p>INSULATED</p> <p>1.5 x 4.5mm BLUE AW51150034 2.0 x 4.5mm RED AW51200034</p> <p>NON - INSULATED</p> <p>2.0 x 4.5mm AW52200034</p> <p>TEFLON</p> <p>2.0 x 4.0mm RED AW53200034</p>
<p>③ CONTACT TIP HOLDER</p> <p>M6 - L35 AW31008635 M8 - L35 AW31008835</p>	<p>⑥ LINER COLLET</p> <p>INSULATED / NON INSULATED</p> <p>4.5 mm OD BLUE AW59450102 4.5 mm OD RED AW59450103</p> <p>TEFLON</p> <p>4.0 mm OD AW59400106</p>	
<p>④ SWITCH</p> <p>TRIGGER AW61000021 MICRO AW61000022</p>		

(X) CONTACT TIP SIZE :- REPLACE LAST TWO DIGITS SHOWN 'XX' WITH WIRE SIZE
 FOR EXAMPLE : WIRE SIZE 0.8 MM - 08 / 1.2 MM - 12